

## NOTES:

To achieve the best results with the assembly of our bases, we strongly recommend thread locking all screws (apply to full length of screw) and using a spanner and socket drill to tighten nuts.

## PARTS:

A	B	C	D	E	F	G	H	TOOL	TOOL	TOOL	TOOL
X1	X1		X1	X1	X3	X1	X1	NOT INCLUDE	NOT INCLUDED	NOT INCLUDED	NOT INCLUDED
					16MM NUT	WASHER	BOLT	ALLEN KEY	THREAD LOCK	16MM SPANNER	16MM SOCKET DRILL

## DIAGRAM:

STEP 1:

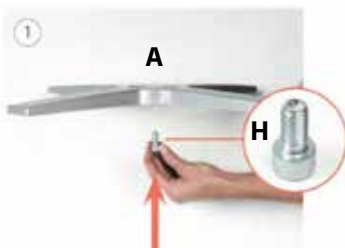

STEP 2:

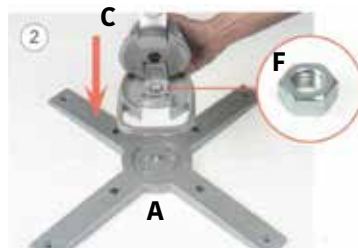

STEP 3:



STEP 4:

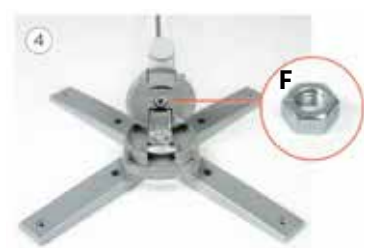

STEP 5:

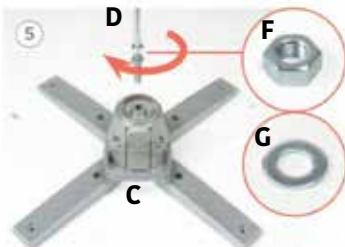

STEP 6:

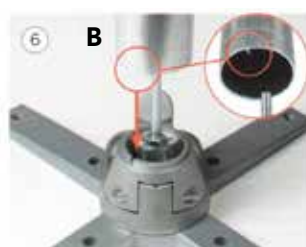

STEP 7:



COMPLETE:



STEP 8:

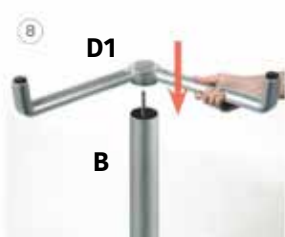

STEP 9:



STEP 10:

